

Installing Large Machine Screw Anchors for Large Eyebolt and Nut

The following instructions are for installing the Large Eyebolt and Large Machine Screw Anchor in a solid masonry surface at each Corner Hardware location.

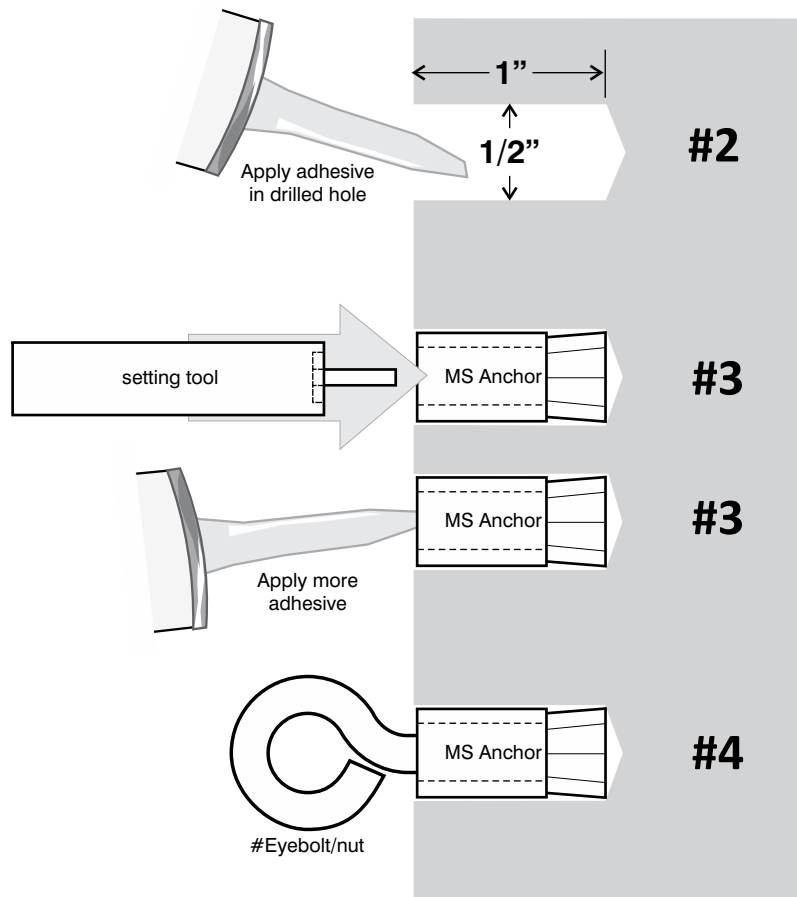

#1. Mark the location of each Corner Hardware set. To secure the Large Eyebolt (#Eyebolt/nut), you will need to install the large Machine Screw Anchor (#MS-Anchor LG). Both the Eyebolt and Anchor have 1/4-20 threads.

#2. Drill a 1/2" (1.27cm) diameter hole, 1" (2.54cm) deep at each location. Clean out all excess dust or debris. Apply small quantity of adhesive/sealer in the hole.

#3. Using the Setting Tool (# Setting Tool LG), seat the anchor in the hole by striking the Setting Tool with a hammer until the sleeve is seated. Apply another dab of adhesive inside the anchor.

#4. Complete the installation by threading the Large Eyebolt (#Eyebolt w/nut) into the machine screw anchor. Thread the eyebolt into the anchor as far as it will go. Wipe off any excess adhesive that is pushed out of the hole.

The adhesive is to help keep water from getting into the drilled holes. For this application, we recommend the ECO-BOND Sealer/Adhesive (#EBCLR125).

For best results use a high quality masonry drill bit. Increase hole depth for anchor if masonry is in poor condition. Do not drill holes close to edges of masonry.

If you have any questions or would like more information, please contact Nixalite® of America Inc



Nixalite® of America Inc
1025 16th Ave, East Moline, IL. 61244
Providing Superior Bird Control Since 1950

P: 800.624.1189 or 309.755.8771
F: 800.624.1196 or 309.755.0077
E: birdcontrol@nixalite.com
www.nixalite.com